

## For optimised and connected pool management

Private Pools

AYAC100571

MasterBox comprises all electrical and support protection devices, as well as smart management of filtration and the following additional components: water treatment system (pH and chlorine regulators), lighting, heating and booster pump. It also serves to view the status of the cover.

MasterBox is accessible by Bluetooth via an application.

Equipped with an **AvadyConnect kit**, it also offers users the option to manage and control their equipment remotely.

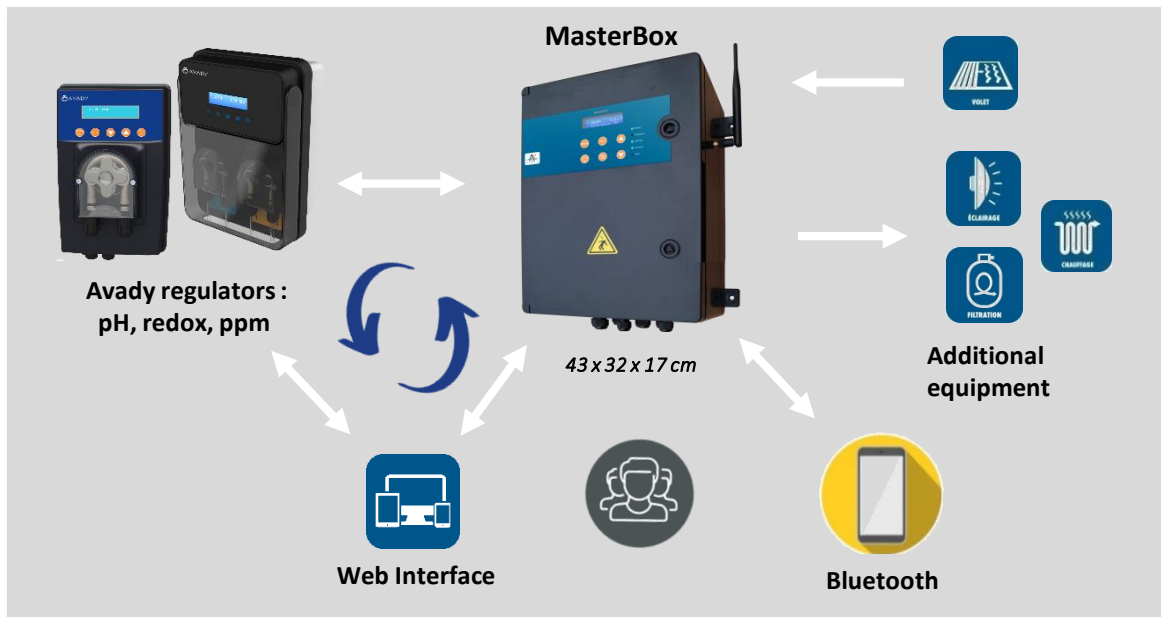

- All connections to external components are grouped in a single terminal block with pre-wired power connections.



- Two relays with smart digital thermal protection. Single-phase 230 V, withstanding up to 2.2 kW



- 30 mA protection and protection against short-circuits

### MasterBox® Bluetooth Web

Autonomous filtration management, max. 2.2 kW	●
Smartphone application	●
Temperature control	●
Anti-freeze protection	●
Two auxiliary outputs for management of: <b>temperature and pool lighting</b> , timer or manual modes (voltage-free dry contacts)	●
One 230 V AC auxiliary output with pre-wired power connections for water treatment management	●
Cover detection input (voltage-free dry contact)	●
Automatic detection of rating of filtration pumps and booster pump	●
Protection against short-circuits	●
30 mA differential protection	●
Measurement of air and water temperature	●
Management of robotic cleaner booster pump, max. 2.2 kW	●
Professional terminal block mounted on DIN rail	●
Updates via USB flash drive	●
Remote control*	●
Receipt of pH and chlorine data*	●
Display of pool graphs and history	●
Detection of low pH and chlorine levels	●

\* Compatible with PROpilot and Turboxy® ranges

Equipped with an AvadyConnect Kit



## Key aspects MasterBox® Bluetooth Web

- Access to the main MasterBox® functions and Avady (or compatible) treatment devices, via a web interface available at [www.avadyconnect.com](http://www.avadyconnect.com).
- If the communication systems of water treatment devices are compatible with the Avady communication system, the measurements taken will be relayed to the web interface, which also offers historical data, alarm management, and the option to modify device settings remotely. The electrical power supply to water treatment devices can be adjusted if the systems are not compatible, so that MasterBox® can be used with all water treatment devices available on the market.



A single glance is enough:  
If settings are green, it's safe to swim !

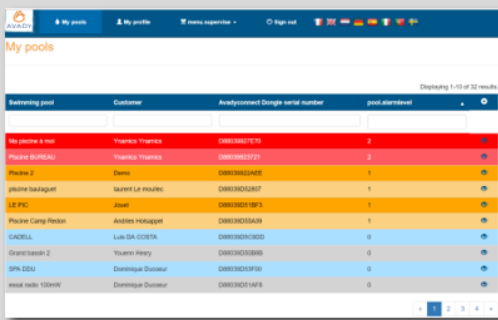

List of managed pools

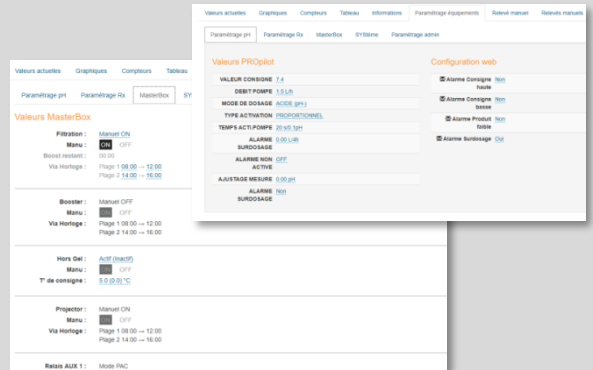

Management of water treatment (pH, chlorine) and equipment connected to MasterBox.

### Remote control and coordination of:

- Regulation of pH and chlorine levels\*
- Heat pump
- Lighting status
- Low level of treatment products\*\*
- Operation of the filtration pump and booster pump
- Equipment status, e.g. cover
- Alerts and advice via email

\* Compatible with the PROpilot and Turboxy® ranges  
\*\* Depending on the connected device

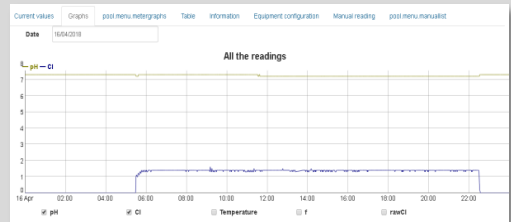

Display of manual measurements and maintenance history (12 months).

## Operation :

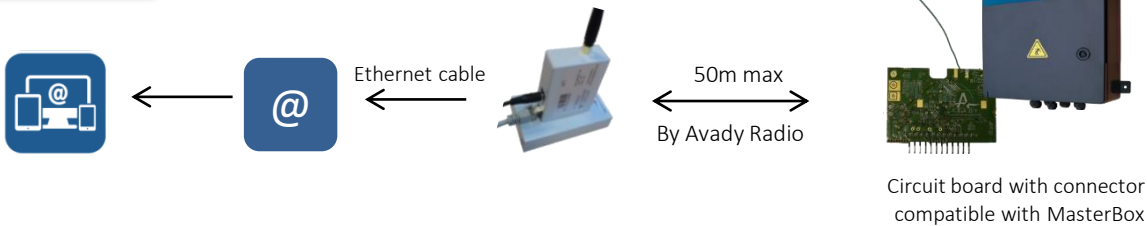

Circuit board with connector compatible with MasterBox



Scan to discover !

AVADY POOL | 9 Chaussée Jules César · Bât 2 Porte 221 B · 95520 OSNY · France  
Tel : +33 (0)1 34 48 16 03 | [contact@avadypool.com](mailto:contact@avadypool.com) | [www.avadypool.com](http://www.avadypool.com)  
It is the user's responsibility to ensure that these products meet their needs.

